

## FlipUp™ Frame

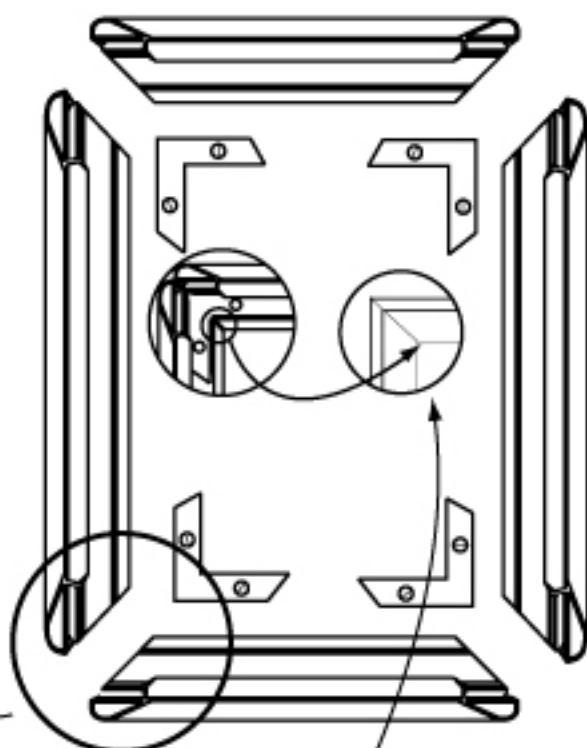

### Frame assembly (if necessary)

1. Flip open frame edges.
2. Insert corners, tighten screws.  
Screws tighten down to the bottom of channel, friction hold.
3. Make sure that bottom miter corners are aligned with no gaps.

Frame can be mounted to surface with double sided tape, or if screwing to surface, SEE BELOW.



After assembling your frame, or after receiving your assembled frame, it may have gaps or mis-alignment at the corners.  
OR, corners may bind (get stuck at the corners).

TO FIX: simply adjust 1 or all 4 of the frame edges by sliding them slightly to one side or the other.

To slide frame edge, quickly wobble\* or rotate the edge up and down while pushing in the direction you want.

*\*Do not just push the frame without the quick up and down rotation because you may pop the springs out.*

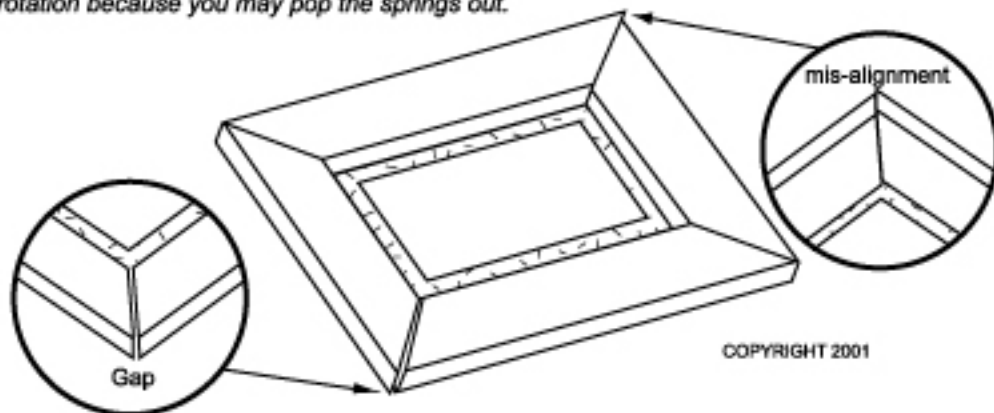
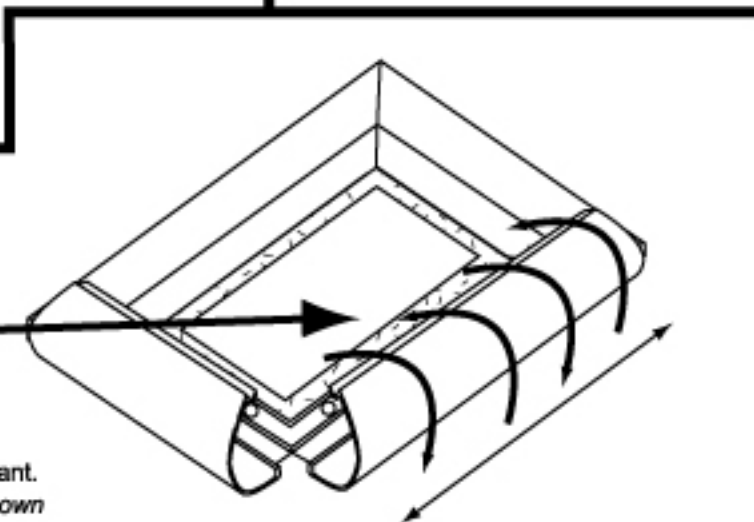

Remember:  
The frame miters were cut to accept a specific thickness insert at the time it was ordered. If thicker or thinner inserts are used, miters may have gaps or bind, but should still work fine to hold your graphic.

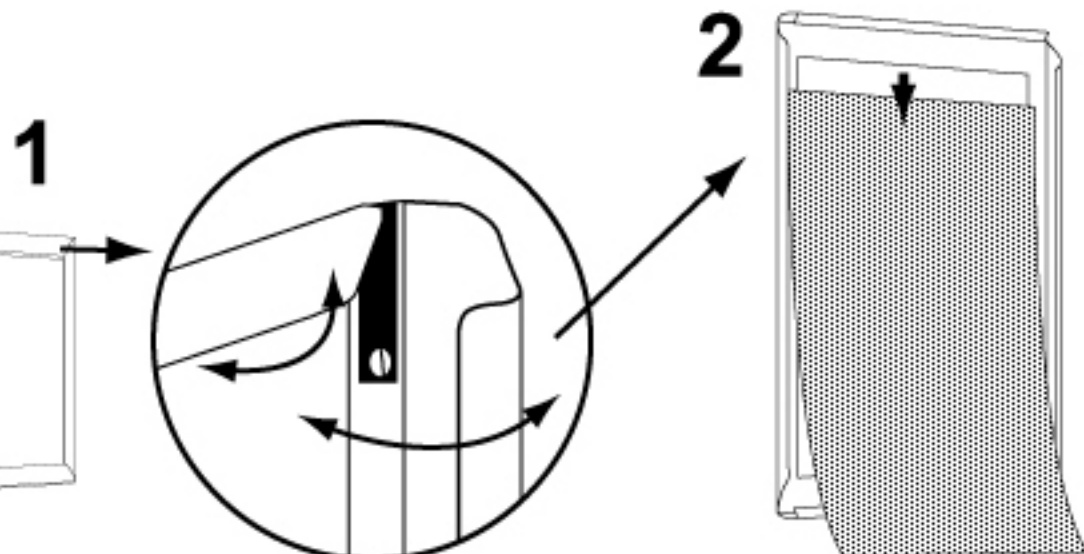

1. Open all four frame edges.

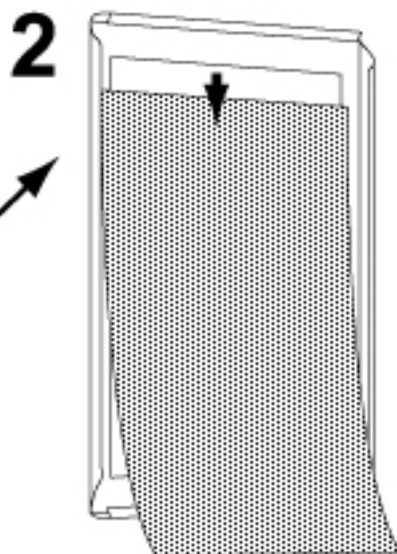

2. Insert graphic in holding cavity.

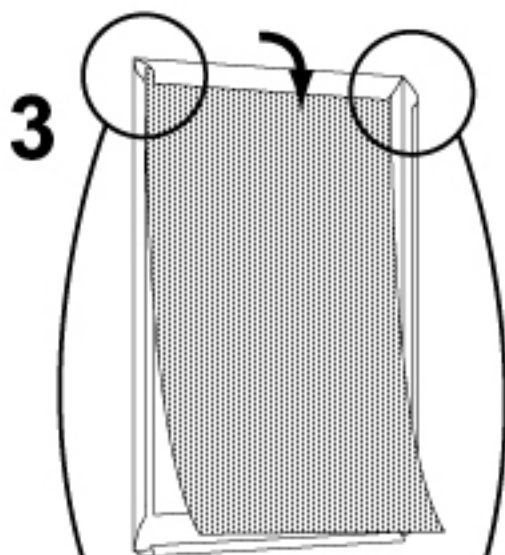

3. Make sure graphic is aligned properly. Then, flip down top frame edge, and then the remaining three edges.

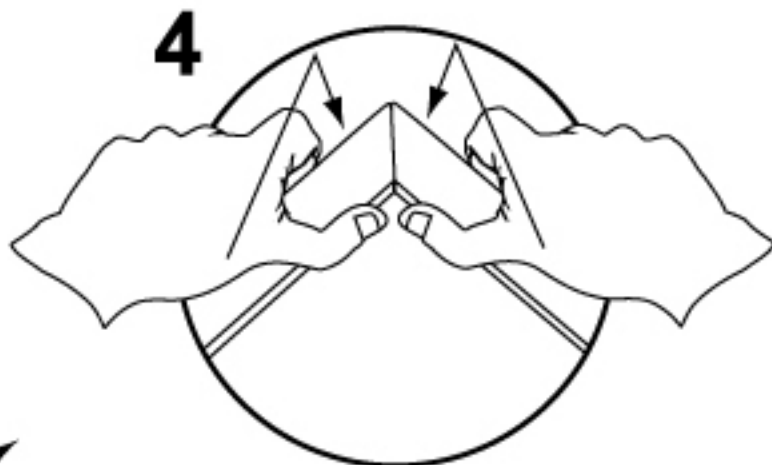

4. Snap corners down into alignment by pushing slightly outward on both frame edges as you rotate down.

Push corners down into alignment - they should "snap down."